

## VALVOLE MONO/BITUBO MONO/BITUBE VALVE

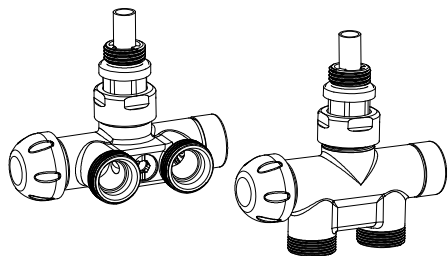

Valvola modello mono / bitubo tramite by-pass, versione a squadra o diritta con attacchi per tubo rame o plastica. Interasse 40 o 50 mm.

### Caratteristiche tecniche

Max pressione statica di esercizio: 10 bar  
Max temperatura : 110°C  
Max pressione differenziale : 1 bar

Mono / bitube valve model by-pass, angled or straight version with connections for copper or plastic pipe. Distance between connections 40 or 50 mm.

### Operating features

Max static operating pressure: 10 bar  
Max operating temperature: 110°C  
Max differential pressure: 1 bar

### DIREZIONE DEL FLUSSO FLOW DIRECTION

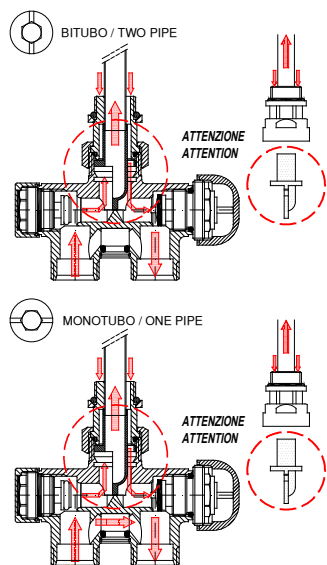

## INSTALLAZIONE INSTALATIONS

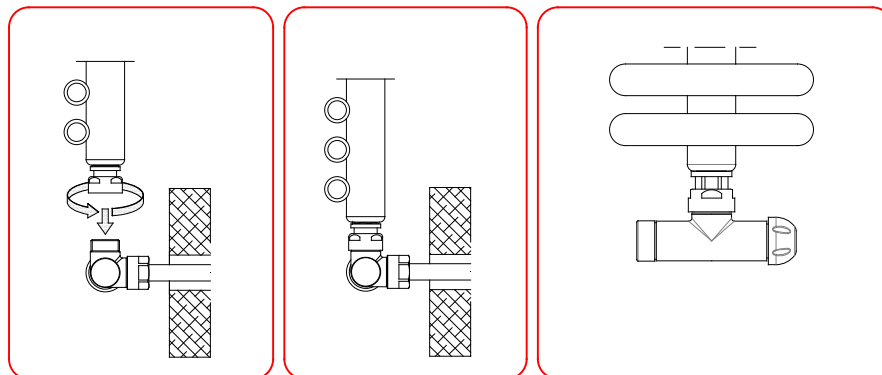
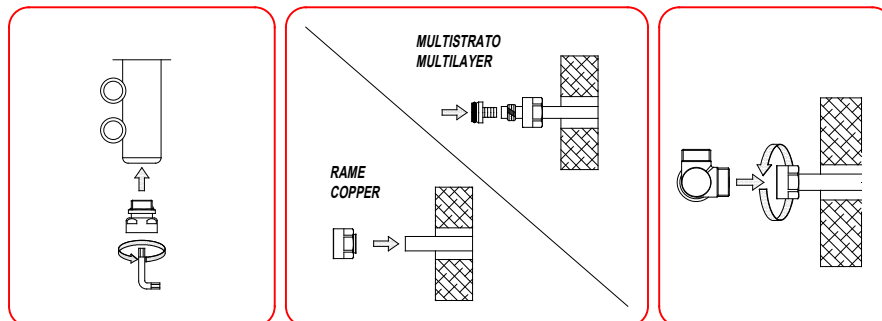

### CONFIGURAZIONE CONFIGURATION

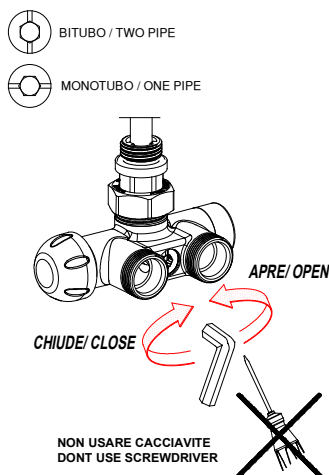

### REGOLAZIONE VALVOLA VALVE REGULATION

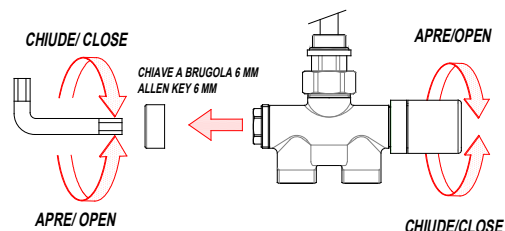

## PREREGOLAZIONE PRESETTING

Solo per modelli con questa funzione / Only for models with this function

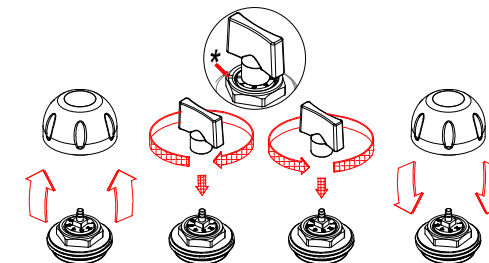

1. Togliere il cappuccio / Take off the cap;
2. Chiudere la ghiera di prerogolazione / Close presetting ring nut;
3. Aprire la ghiera e far coincidere l'indice con uno dei numeri / Open the ring and make the index coincide with one of the numbers;
4. Mettere il cappuccio / Install the cap.

## TESTA TERMOSTATICA THERMOSTATIC HEAD

INSTALLAZIONE PER LE VALVOLE CON CAPPUCCIO  
INSTALLATION FOR VALVES WITH CAP

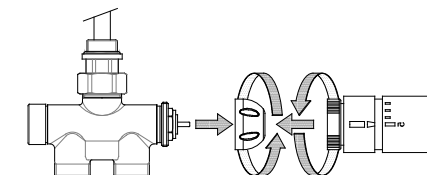

1. Togliere il cappuccio di protezione / Take off the protection cap;
2. Selezionare l'impostazione "5" sulla testa termostatica / Select setting "5" on the thermostatic head;
3. Installare la testa termostatica avvitando manualmente il dado ad anello / Install the thermostatic head by screwing the ring nut manually.

INSTALLAZIONE PER LE VALVOLE CON MANOPOLA TERMOSTATIZZABILE  
INSTALLATION FOR VALVES WITH THERMOSTATIC HANDWHEEL

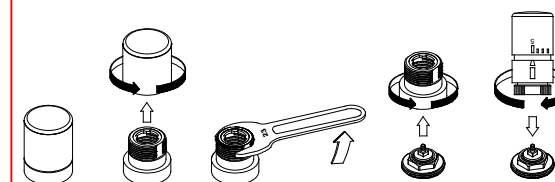

## SQUADRA / ANGLED

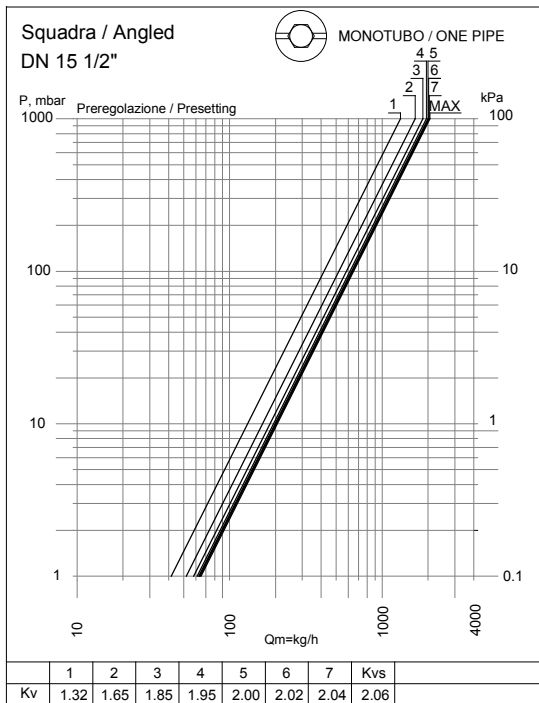
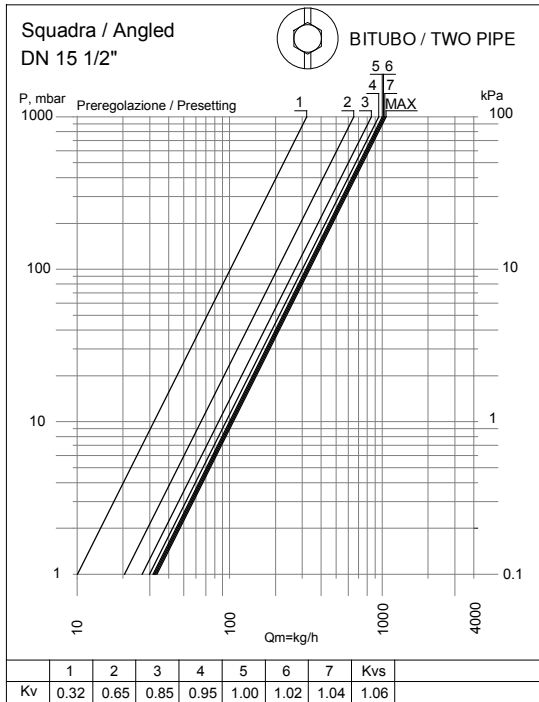

## DIRITTA / STRAIGHT

