

# Zehnder Arteplano

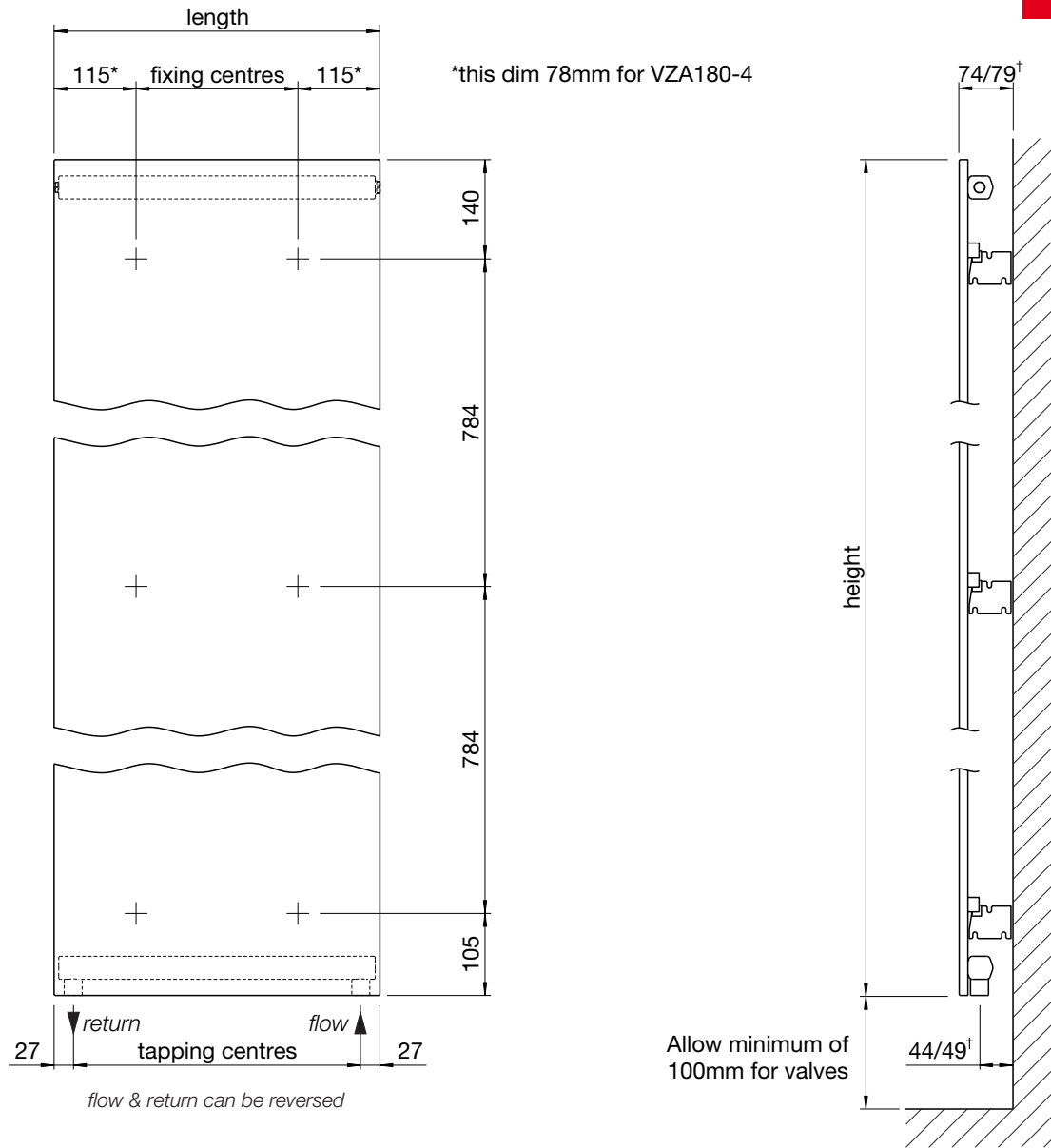

All dimensions shown are in millimetres

Test pressure: **5.2 BAR**  
 Max working pressure: **4.6 BAR**  
 Max working temperature: **85° C**  
 All steel construction: **32mm x 37mm steel headers**  
**8mm x 70mm steel ribs**  
**1.2mm thick panel - aluminium, copper, brass or stainless steel**

Connections: **1/2 inch BSP underside tappings**

Heat output determined in accordance with EN 442  
 Test Laboratory: HLK STUTTGART, Test Lab Registration No: 0626

† Dimensions vary according to bracket position.  
 With smaller dimension it is not possible to have angled valves back to the wall (see fitting instructions)

\* Mirror finish of this product has a 9% reduction in output

Model	Height ± 2mm	Width ± 2mm	Finish	Output ΔT=50K		Output ΔT=30K		n	Weight kg	Water Content litres
				Watts	Btu	Watts	Btu			
VZA180-4	1813	305	all	517	1764	266	908	1.3	22.8	2.9
VZA180-6	1813	453	all	780	2661	401	1368	1.3	34.1	4.3
VZA180-8	1813	601	all	1042	3555	536	1829	1.3	45.5	5.8

Issue 1.1



Zehnder Group UK Ltd

Concept House  
 Watchmoor Point  
 Camberley  
 Surrey GU15 3AD

Tel: 01276 605800  
 Fax: 01276 24058  
 retailsales@zehnder.co.uk  
 www.zehnder.co.uk

Registered in England: 2296696

## Tools & Material Required

Wall plugs - to suit screws  
 Screws - Hex head, 7mm diameter x 55mm length  
 Suitable valves  
 PTFE tape  
 Silicone thread sealant  
 Tape measure  
 Allen key - 13mm & 12mm (when installing Zehnder valves)  
 Spanner - 14mm  
 Screwdriver  
 Electric drill  
 Masonry drill bit - to suit wall plugs  
 Spirit level  
 Stepladder (for taller radiators)

Key	Component	Qty
A	Air Vent - 1/4"	1
B	Blanking Plug	1
C	Wall Plug*	6
D	Bracket	6
E	Screw - hex head, 7mm dia x 55mm*	6
F	Security Clip (optional)	2

\* Wall Plugs & Screws not supplied

## Assembly Instructions

Sufficient PTFE tape must be applied to valve-tail threads prior to their installation.

Silicone thread sealant should be applied to all threaded components manufactured with 'O-rings'.

Fit valve tails, using correct size Allen key.

Fit air vent (A) & blanking plug (B).

Accurately mark out six bracket holes on wall using spirit level, to dimensions as shown on Technical Data Sheet.

Drill four holes & insert wall plugs (C).

Attach brackets (D) to wall with screws (E).

Note: brackets have two possible mounting positions (see below). Increasing the spacing from the wall will allow for angled valves to connect to pipes from the wall.

Hang radiator onto brackets (D).

If required, fit security clips (F) in position on top brackets (D).

Plumb radiator to heating circuit with flow opposite air vent.

This radiator should be installed onto a central heating system that has been cleaned/flushed and contains water treatment and inhibitors in accordance with BS7593.

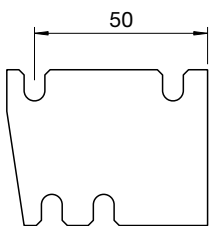
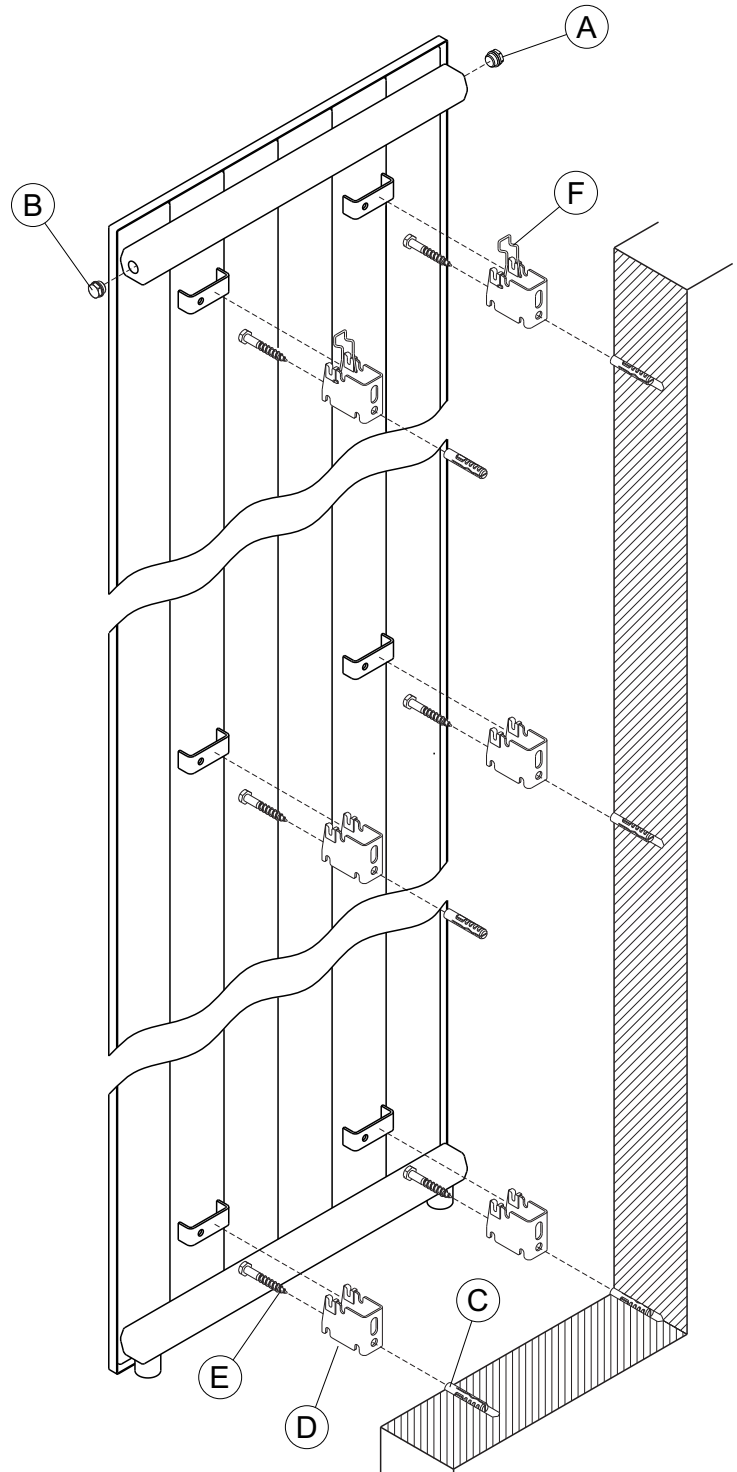

**Bracket Position 1**

Angled valve sets D,Z,F,K, M & Q can be used for pipe connections from wall

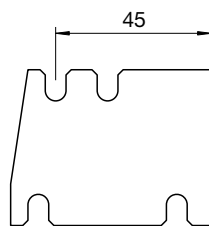

**Bracket Position 2**

Radiator will be closer to wall, but there will be insufficient space for angled